

→ eAA-7PC (NUL07E-7)

Battery-powered
Crawler type / Articulated boom lift

FEATURES

- ✓ Battery-powered
- ✓ Allowable tilt 5°
- ✓ Zero / Short tail
- ✓ Operation restriction (slope)

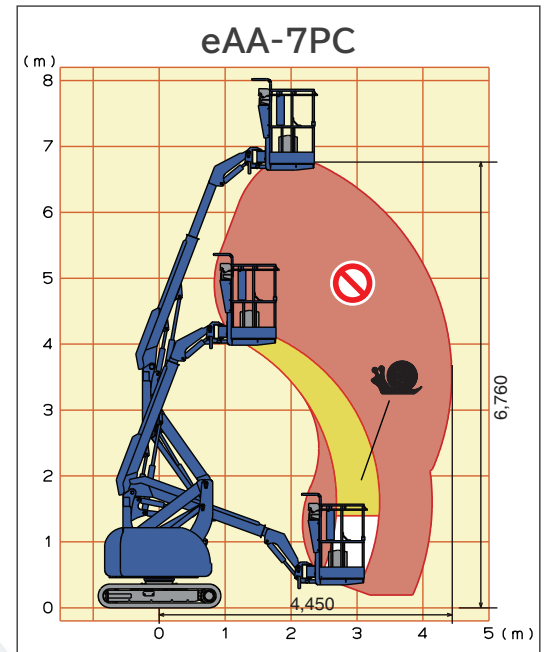

TYPE	eAA-7PC
Platform capacity	150 kg
Allowable tilt	5°
Platform dimensions (W x L x H)	770 x 620 x 1,000 mm
Platform height (max)	6,760 mm
Horizontal reach	4,450 mm
Machine weight	2,740 kg
Overall length	4,080 mm
Overall width	1,650 mm
Overall height	1,995 mm
Battery	6V x 8
Travel speeds	0.8/1.1/2.2 km/h



Lifting the machine

- ⚠ Use only qualified rigging to hoist the machine.
- ⚠ Be sure that lifting devices and crane are sufficient to withstand the machine weight.
- Ensure the boom is in stowed position before lifting.
- Determine the center of gravity of the machine as shown below.
- Attach the rigging to designated lifting rings on the machine.
- Insert protective materials where rigging may interfere with the machine.

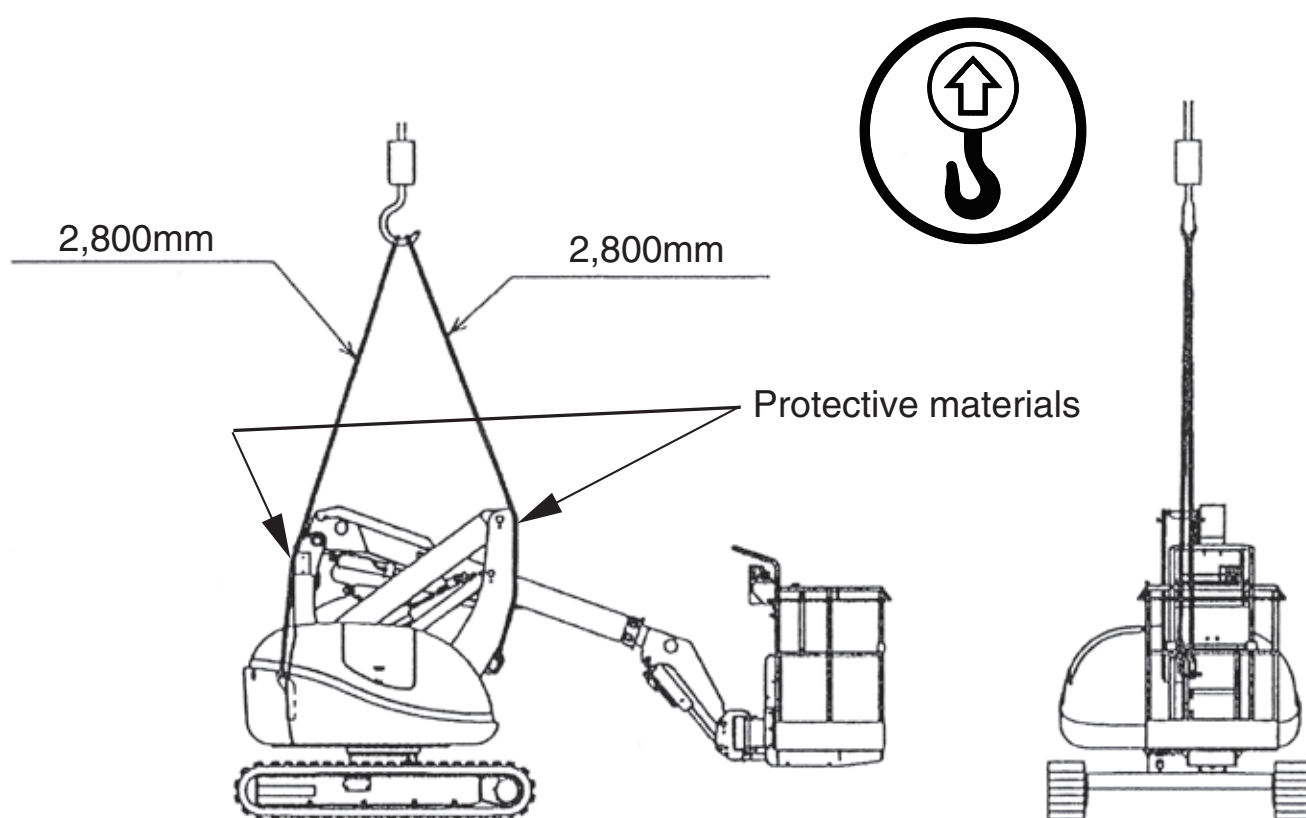

Tadano Ltd.

Kanda Square 18th Floor, 2-2-1 Kanda-Nishikicho, Chiyoda-ku, Tokyo 101-0054, Japan

Phone: +81-3-6811-7309

info@tadano.com

www.tadano.com